

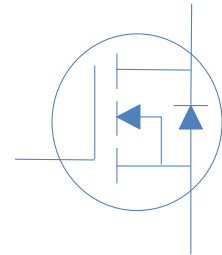

100V N-Ch Power MOSFET

V_{DS}		100	V
$R_{DS(on),typ}$	$V_{GS}=10V$	26	mΩ
I_D (Silicon Limited)		50	A



Part Number	Package	Marking
HTD300N10	TO-252	TD300N10

Absolute Maximum Ratings at $T_J=25$ (unless otherwise specified)

Parameter	Symbol	Conditions	Value	Unit
Continuous Drain Current (Silicon Limited)	I_D	$T_C=25$	50	A
		$T_C=100$	35	
Drain to Source Voltage	V_{DS}	-	100	V
Gate to Source Voltage	V_{GS}	-	±20	V
Pulsed Drain Current	I_{DM}	-	150	A
Avalanche Energy, Single Pulse	E_{AS}	$L=0.1mH, T_C=25$	45	mJ
Power Dissipation	P_D	$T_C=25$	50	W
Operating and Storage Temperature	T_J, T_{stg}	-	-55 to 150	

Absolute Maximum Ratings

Parameter	Symbol	Max	Unit
Thermal Resistance Junction-Ambient	$R_{θJA}$	75	°W
Thermal Resistance Junction-Case	$R_{θJC}$	2.5	°W

Electrical Characteristics at $T_J=25$ (unless otherwise specified)
Static Characteristics

Parameter	Symbol	Conditions	Value			Unit
			min	typ	max	
Drain to Source Breakdown Voltage	$V_{(BR)DSS}$	$V_{GS}=0V, I_D=250\mu A$	100	-	-	V
Gate Threshold Voltage	$V_{GS(th)}$	$V_{GS}=V_{DS}, I_D=250\mu A$	1	1.7	3	
Zero Gate Voltage Drain Current	I_{DSS}	$V_{GS}=0V, V_{DS}=80V, T_J=25$	-	-	1	μA
		$V_{GS}=0V, V_{DS}=70V, T_J=125$	-	-	25	
Gate to Source Leakage Current	I_{GSS}	$V_{GS}=\pm 20V, V_{DS}=0V$	-	-	± 100	nA
Drain to Source on Resistance	$R_{DS(on)}$	$V_{GS}=10V, I_D=30A$	-	26	30	m Ω
		$V_{GS}=4.5V, I_D=20A$	-	28	35	
Transconductance	g_{fs}	$V_{DS}=5V, I_D=30A$	-	38	-	S
Gate Resistance	R_G	$V_{GS}=15mV, V_{DS}=0V, f=1MHz$	-	1.5	-	Ω

Dynamic Characteristics

Input Capacitance	C_{iss}	$V_{GS}=0V, V_{DS}=50V, f=1MHz$	-	2725	-	pF
Output Capacitance	C_{oss}		-	209	-	
Reverse Transfer Capacitance	C_{rss}		-	57	-	
Total Gate Charge	$Q_g(10V)$	$V_{DD}=50V, I_D=30A, V_{GS}=10V$	-	38	-	nC
Gate to Source Charge	Q_{gs}		-	6.8	-	
Gate to Drain (Miller) Charge	Q_{gd}		-	9.1	-	
Turn on Delay Time	$t_{d(on)}$	$V_{DD}=50V, I_D=1A, V_{GS}=10V, R_G=6\Omega,$	-	25	-	ns
Rise time	t_r		-	110	-	
Turn off Delay Time	$t_{d(off)}$		-	100	-	
Fall Time	t_f		-	120	-	

Reverse Diode Characteristics

Diode Forward Voltage	V_{SD}	$V_{GS}=0V, I_F=50A$	-		1.3	V
Reverse Recovery Time	t_{rr}	$I_F=25A, di_F/dt=100A/\mu s$	-	120	-	ns
Reverse Recovery Charge	Q_{rr}		-	380	-	nC

Fig 1. Typical Output Characteristics

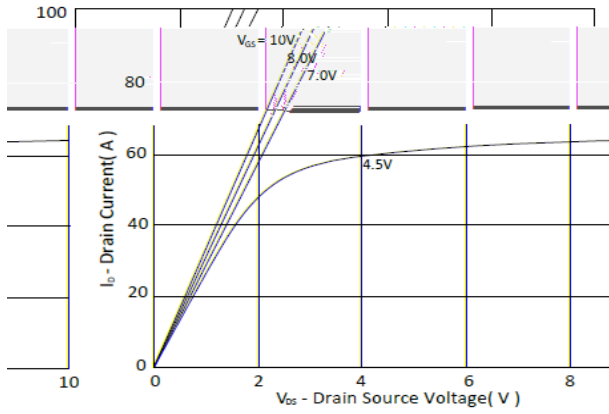

Figure 2. On-Resistance vs. Gate-Source Voltage

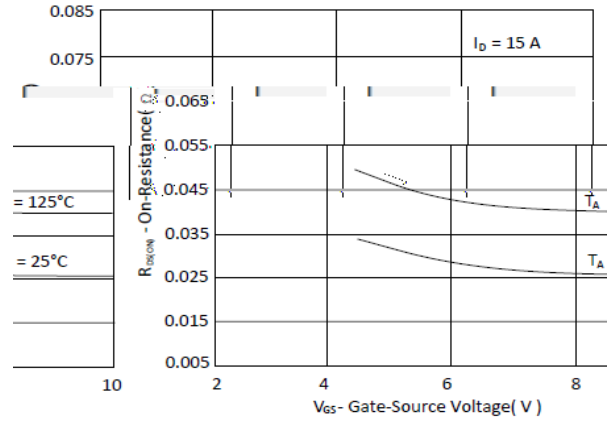

Figure 3. On-Resistance vs. Drain Current and Gate Voltage

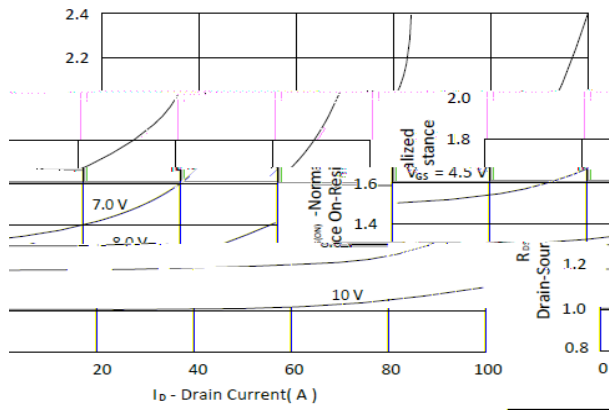

Figure 4. Normalized On-Resistance vs. Junction Temperature

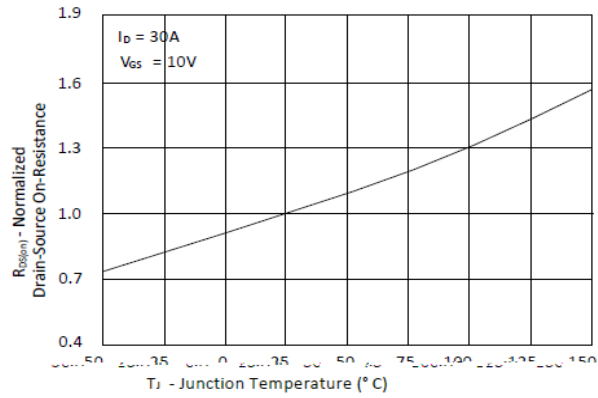

Figure 5. Typical Transfer Characteristics

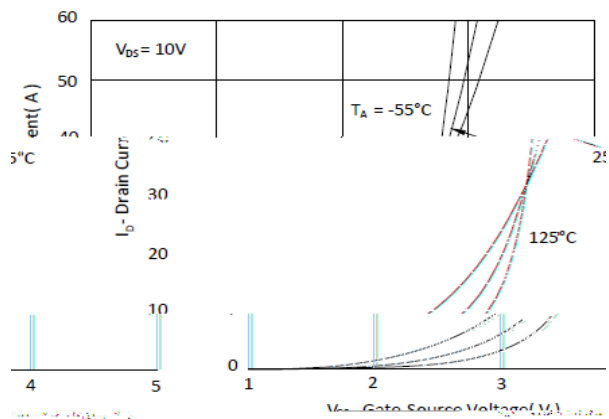

Figure 6. Typical Source-Drain Diode Forward Voltage

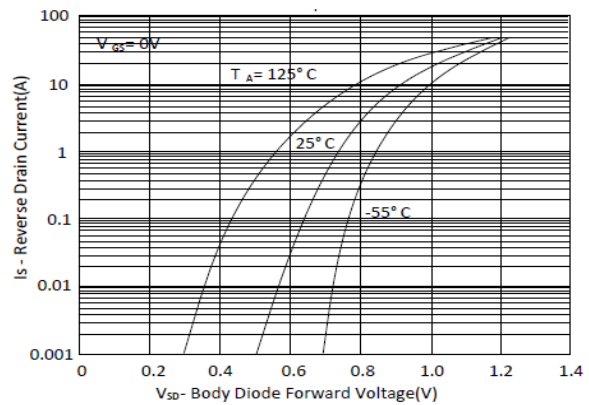

Figure 7. Typical Gate-Charge vs. Gate-to-Source Voltage

Figure 8. Typical Capacitance vs. Drain-to-Source Voltage

Figure 9. Maximum Safe Operating Area

Figure 10. Single Pulse Maximum Power Dissipation

Figure 11. Normalized Maximum Transient Thermal Impedance, Junction-to-Ambient

Inductive switching Test

--	--

Gate Charge Test

--	--

Uclamped Inductive Switching (UIS) Test

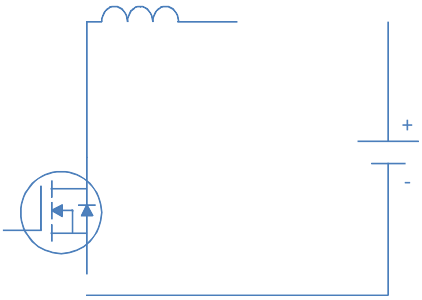
	
---	--

Diode Recovery Test

--	--

Package Outline

TO-252, 3leads

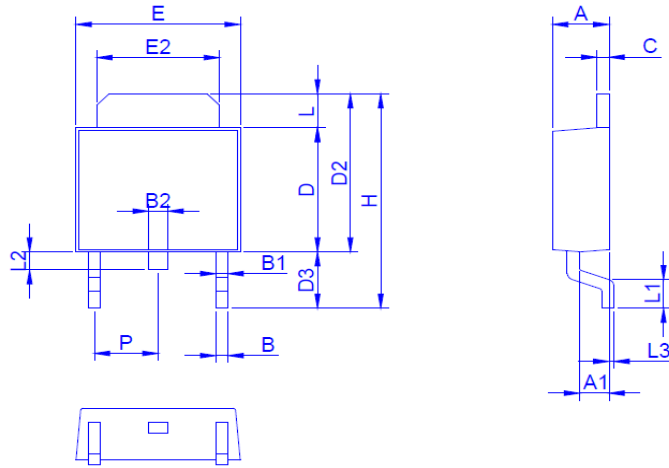

Dimension	A	A1	B	B1	B2	C	D	D2	D3	E	E2	H	L	L1	L2	L3	P	
	0.60	0.40	5.30	6.70	2.20	6.40	4.80	9.20	0.89	0.90	0.50	0.00	2.10	Min.	2.10	0.95	0.30	0.40
	1.00	0.60	6.20	7.30	3.00	6.70	5.45	10.15	1.70	1.65	1.10	0.30	2.50	Max.	2.50	1.30	0.85	0.90